

THIS PLAN IS THE PROPERTY OF THE ARCHITECT AND IS NOT TO BE REPRODUCED OR COPIED IN ANY MANNER WITHOUT HIS WRITTEN PERMISSION.

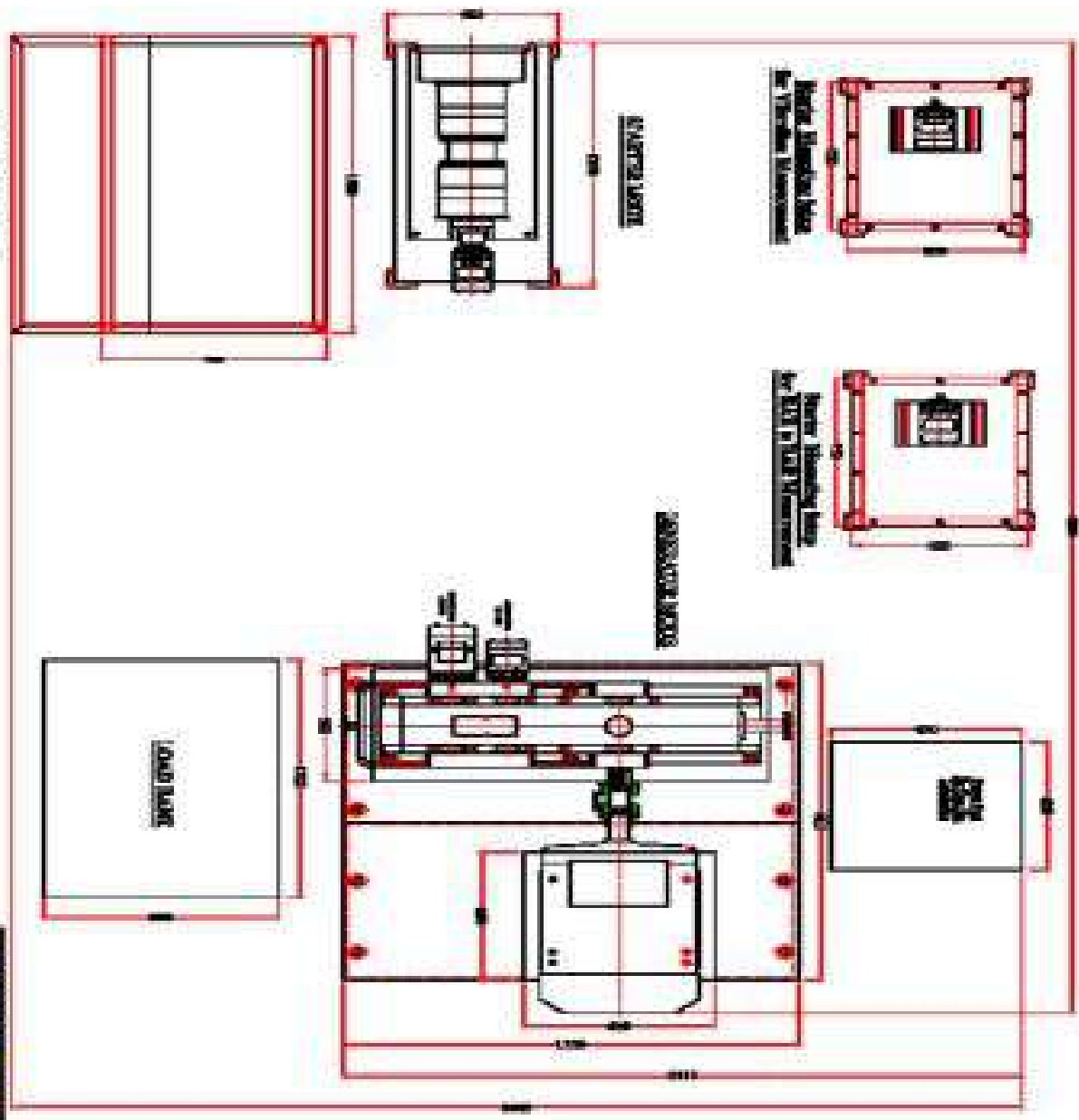

STAIRS

RESTAURANT ROOM

High Seating Area by Theodor Ahrenberg

High Seating Area by Theodor Ahrenberg

RESTAURANT ROOM

LUNCH BAR

RESTROOM

STAIRS

NO. 1	1/2" x 1/2" x 1/2"	1/2"	1/2"	1/2"
NO. 2	1/2" x 1/2" x 1/2"	1/2"	1/2"	1/2"
NO. 3	1/2" x 1/2" x 1/2"	1/2"	1/2"	1/2"
NO. 4	1/2" x 1/2" x 1/2"	1/2"	1/2"	1/2"
NO. 5	1/2" x 1/2" x 1/2"	1/2"	1/2"	1/2"
NO. 6	1/2" x 1/2" x 1/2"	1/2"	1/2"	1/2"
NO. 7	1/2" x 1/2" x 1/2"	1/2"	1/2"	1/2"
NO. 8	1/2" x 1/2" x 1/2"	1/2"	1/2"	1/2"
NO. 9	1/2" x 1/2" x 1/2"	1/2"	1/2"	1/2"
NO. 10	1/2" x 1/2" x 1/2"	1/2"	1/2"	1/2"
NO. 11	1/2" x 1/2" x 1/2"	1/2"	1/2"	1/2"
NO. 12	1/2" x 1/2" x 1/2"	1/2"	1/2"	1/2"
NO. 13	1/2" x 1/2" x 1/2"	1/2"	1/2"	1/2"
NO. 14	1/2" x 1/2" x 1/2"	1/2"	1/2"	1/2"
NO. 15	1/2" x 1/2" x 1/2"	1/2"	1/2"	1/2"
NO. 16	1/2" x 1/2" x 1/2"	1/2"	1/2"	1/2"
NO. 17	1/2" x 1/2" x 1/2"	1/2"	1/2"	1/2"
NO. 18	1/2" x 1/2" x 1/2"	1/2"	1/2"	1/2"
NO. 19	1/2" x 1/2" x 1/2"	1/2"	1/2"	1/2"
NO. 20	1/2" x 1/2" x 1/2"	1/2"	1/2"	1/2"
NO. 21	1/2" x 1/2" x 1/2"	1/2"	1/2"	1/2"
NO. 22	1/2" x 1/2" x 1/2"	1/2"	1/2"	1/2"
NO. 23	1/2" x 1/2" x 1/2"	1/2"	1/2"	1/2"
NO. 24	1/2" x 1/2" x 1/2"	1/2"	1/2"	1/2"
NO. 25	1/2" x 1/2" x 1/2"	1/2"	1/2"	1/2"
NO. 26	1/2" x 1/2" x 1/2"	1/2"	1/2"	1/2"
NO. 27	1/2" x 1/2" x 1/2"	1/2"	1/2"	1/2"
NO. 28	1/2" x 1/2" x 1/2"	1/2"	1/2"	1/2"
NO. 29	1/2" x 1/2" x 1/2"	1/2"	1/2"	1/2"
NO. 30	1/2" x 1/2" x 1/2"	1/2"	1/2"	1/2"
NO. 31	1/2" x 1/2" x 1/2"	1/2"	1/2"	1/2"
NO. 32	1/2" x 1/2" x 1/2"	1/2"	1/2"	1/2"
NO. 33	1/2" x 1/2" x 1/2"	1/2"	1/2"	1/2"
NO. 34	1/2" x 1/2" x 1/2"	1/2"	1/2"	1/2"
NO. 35	1/2" x 1/2" x 1/2"	1/2"	1/2"	1/2"
NO. 36	1/2" x 1/2" x 1/2"	1/2"	1/2"	1/2"
NO. 37	1/2" x 1/2" x 1/2"	1/2"	1/2"	1/2"
NO. 38	1/2" x 1/2" x 1/2"	1/2"	1/2"	1/2"
NO. 39	1/2" x 1/2" x 1/2"	1/2"	1/2"	1/2"
NO. 40	1/2" x 1/2" x 1/2"	1/2"	1/2"	1/2"
NO. 41	1/2" x 1/2" x 1/2"	1/2"	1/2"	1/2"
NO. 42	1/2" x 1/2" x 1/2"	1/2"	1/2"	1/2"
NO. 43	1/2" x 1/2" x 1/2"	1/2"	1/2"	1/2"
NO. 44	1/2" x 1/2" x 1/2"	1/2"	1/2"	1/2"
NO. 45	1/2" x 1/2" x 1/2"	1/2"	1/2"	1/2"
NO. 46	1/2" x 1/2" x 1/2"	1/2"	1/2"	1/2"
NO. 47	1/2" x 1/2" x 1/2"	1/2"	1/2"	1/2"
NO. 48	1/2" x 1/2" x 1/2"	1/2"	1/2"	1/2"
NO. 49	1/2" x 1/2" x 1/2"	1/2"	1/2"	1/2"
NO. 50	1/2" x 1/2" x 1/2"	1/2"	1/2"	1/2"

1/2" x 1/2" x 1/2"